

# ROTATOR | ROTATOR - GV 17US 203

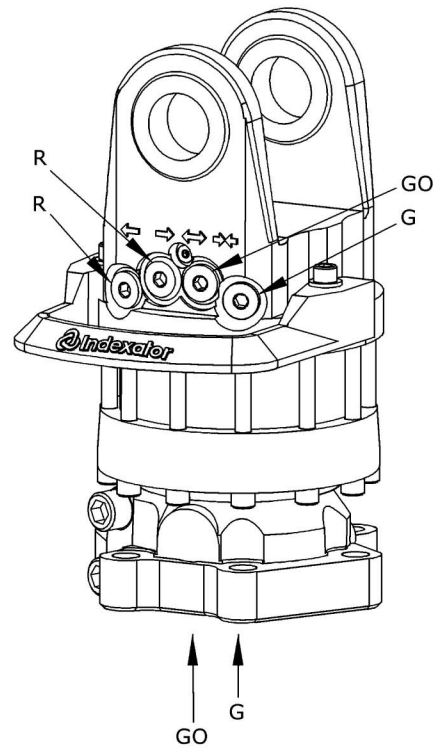
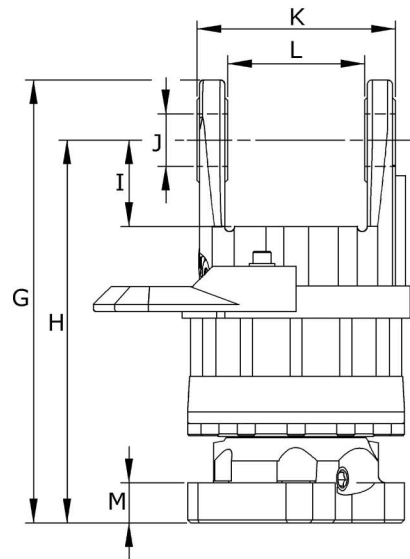
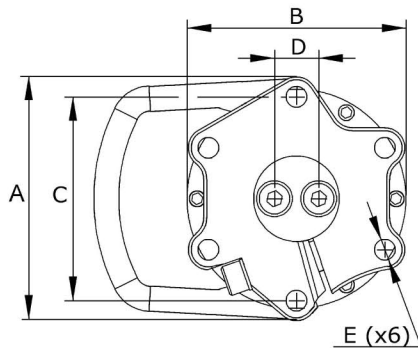

## Technical data

|                        |           |
|------------------------|-----------|
| Part no                | 5217 181  |
| Dimensional drawing    | 2000 826  |
| Hydraulic circuit      | 2100 007  |
| Rotation               | unlimited |
| Weight                 | 69,8 kg   |
| Max axial load, static | 160 kN    |
| Max axial load dynamic | 50 kN     |
| Torque at 25 MPa       | 3300 Nm   |

## Function

| Function            | Max working pressure | Rec oilflow |
|---------------------|----------------------|-------------|
| R = Rotation ⇌      | 25 MPa               | 35 l/min    |
| GO = Grapple open ⇌ | 25 MPa               | *           |
| G = Grapple close ⇌ | 25 MPa               | *           |

## Connections<sup>1</sup>

|       |             |
|-------|-------------|
| Upper | 7/8"-14 UNF |
| Lower | G 1/2       |

<sup>1</sup> We supply adapter sets for alternative connections

\* For more technical information about installation and hydraulic connections, we refer to dimensional drawing and hydraulic circuit as specified above.  
These documents can be ordered at [rotator@indexator.com](mailto:rotator@indexator.com)

## Measure specification

|   | mm     |
|---|--------|
| A | Ø243   |
| B | Ø218   |
| C | Ø203   |
| D | 40     |
| E | Ø21    |
| G | 441    |
| H | 381    |
| I | 88,9   |
| J | Ø52,2* |
| K | 197,5  |
| L | 136,5* |
| M | 40     |

# INTERMERCATO

High performance lift and load  
attachments for Forestry, Transport,  
Construction and Recycling.

